

A POCKET BOTTLE SHOWER MINI

click valve shower head
PBNCV-NB-EN

B HANDY BOTTLE SHOWER MINI

self-closing shower head
HBNSC-GN-EN

USER MANUAL

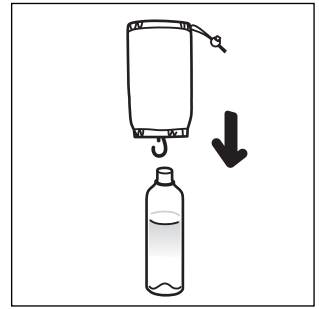

1

Place the bag on the water bottle, making sure the hook is at facing the bottom of the bottle.

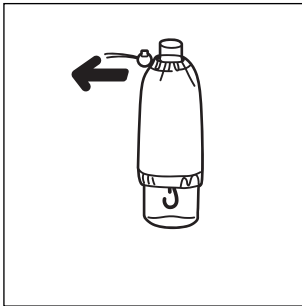

2

Pull the bag tight so that it fits tightly around the bottle.

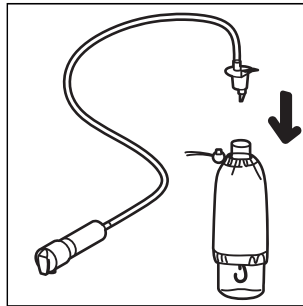

3

Press the adapter into the bottle.

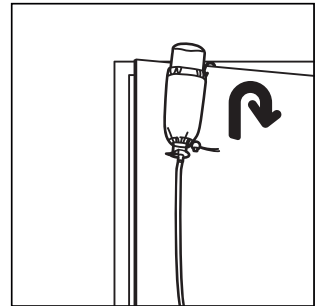

4

Hang the bottle high using a hook. The higher it is from the device, the greater the pressure will be.

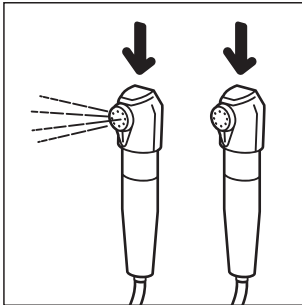

5 A

Pocket Bottle Shower Mini
(click valve shower head)

Activate the shower by pressing the shower head. Stop the water flow by pressing the shower head again.

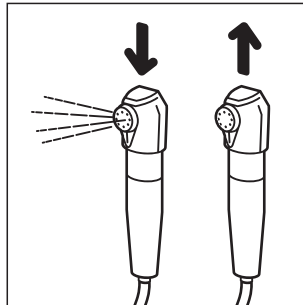

5 B

Handy Bottle Shower Mini
(self-closing shower head)

Activate the shower by pressing and holding the top of the shower head. Release the shower head to stop the water flow.

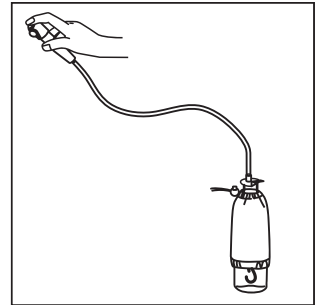

6

After using the device, place the water bottle lower than the shower head. Pressing the shower head, will empty the water inside the hose back to the bottle.